

Exclusives are aluminum flagpoles made of cylindrical tube (same diameter at the whole height of the flagpole)

AVAILABLE ACCESSORIES

Flag display:
 The flag display depends on gusts of wind.

Flag fixing:
 Flag hooks in a slot, flag weight (inside the slot)

Hoisting and lowering of the flag:
 Using the hoisting system with a steel rope and crank (for 75 and 93mm diameter) or using hoisting winch (101mm)

TUBE PROFILE:
 cylindrical aluminum tube with a slot

ANODIZING:
 20 microns

WALL THICKNESS:
 min. 3 mm [75/93 m]
 min. 3,5 mm [101 m]



FINIALS		WEIGHT [kg]
1	Aluminum flat top	0,21
2	Golden bulb/round finial (brass)	0,22
3	Silver bulb/round finial (aluminum)	0,16
4	Black mushroom shaped top (aluminum)	0,142



HALYARD SYSTEM		WEIGHT [kg]
1	Steel rope	0,02 / mb
2	Hoisting system with crank [75/93 mm]	0,086
3	Hoisting winch [101 mm]	0,915
4	Flag weight (inside the slot) [75/93 mm]	0,5
5	Flag weight (inside the slot) [101 mm]	0,8
6	Flag hooks in a slot	0,024

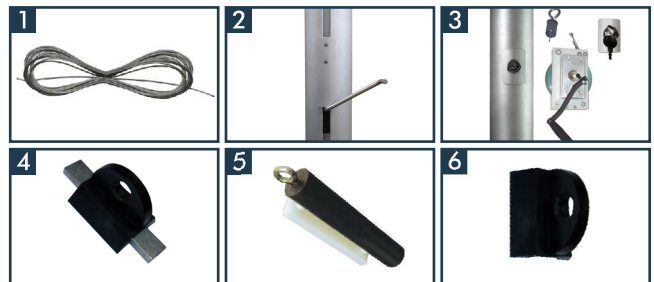

INSTALLATION ELEMENT		WEIGHT [kg]
1	Hinged base plate 75/93/101mm (for foundation)	7,95/9,55 14,75
2	Portable base (for paving stones sized 50x50cm) installation using the upper part of hinged base plate	18,6
3	Ground sleeve 75/93 mm (for foundation)	1 / 1,6

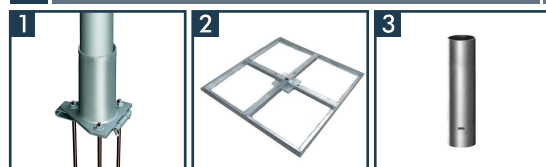

Height [m]	5		6		7		8			9		10		12
Number of sections [pcs]	1		1		1		1			1		1		1
Flagpole diameter (top/bottom) [mm]	75	93	75	93	75	93	75	93	101	93	101	93	101	101
Net weight without accessories [kg]	13,2	17	15,1	20,3	16,8	23,7	21,1	27,1	32,6	30,5	36,7	33,9	40,7	48,84
Recommended size of the flag [m]	3,5x1,2 [4,2 m ²]		3,5x1,2 [4,2 m ²]		3,5x1,2 [4,2 m ²]		4 x 1,5 [6 m ²]			1,5x4 [6 m ²]	1,5x5 [7,5 m ²]	1,5x4 [6 m ²]	1,5x5 [7,5 m ²]	1,5x5 [7,5 m ²]
Size of transport package [cm] ±5% + hinged base plate	560x12x12		660x12x12		760x12x12		860x12x12			960x12x12		1060x12x12		1260x12x12
	510x32x30		610x32x30		710x32x30		810x32x30			910x32x30		1010x32x30		1210x32x30